

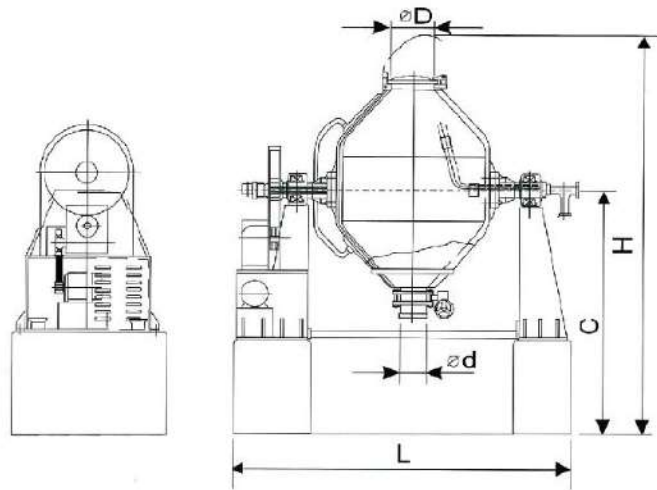

構造圖 (STRUCTURE DIAGRAM)



標準型式規格表(SPECIFICATIONS AND DIMENSIONS)

| 項目<br>ITEM<br>型式<br>MODEL | 全容量<br>TOTAL VOLUME<br>Q | 加熱面積<br>HEATING AREA<br>M | 迴轉數<br>R.P.M<br>MAX.R/M |      | L<br>mm | H<br>mm | C<br>mm | φD<br>mm | φd<br>mm |
|---------------------------|--------------------------|---------------------------|-------------------------|------|---------|---------|---------|----------|----------|
| DVD-20                    | 200                      | 1.5                       | 12                      | 0.75 | 2500    | 2100    | 1200    | 8B       | 8B       |
| DVD-60                    | 600                      | 3.3                       | 8                       | 8    | 2850    | 3730    | 1500    | 450      | 10B      |
| DVD-120                   | 1200                     | 5.4                       | 7                       | 2.2  | 3500    | 2880    | 1500    | 450      | 10B      |
| DVD-200                   | 2000                     | 8.57                      | 6                       | 3.7  | 4100    | 3000    | 1500    | 450      | 10B      |
| DVD-300                   | 3000                     | 10.15                     | 6                       | 5.5  | 4500    | 3300    | 1600    | 450      | 10B      |
| DVD-400                   | 4000                     | 12.46                     | 5                       | 7.5  | 5000    | 3520    | 1700    | 450      | 10B      |
| DVD-550                   | 5500                     | 15.46                     | 5                       | 11   | 5500    | 3770    | 1800    | 450      | 10B      |
| DVD-700                   | 7000                     | 18.2                      | 5                       | 11   | 5700    | 4020    | 1950    | 450      | 10B      |
| DVD-900                   | 9000                     | 21.0                      | 4                       | 15   | 6000    | 4300    | 2100    | 450      | 10B      |
| DVD-1500                  | 15000                    | 30.8                      | 4                       | 22   | 7000    | 4950    | 2400    | 450      | 10B      |

附註：除上述規格及尺寸外，可依實際使用情形，設計製造。

Remark: Besides of the above specifications & Dimensions, others can be designed and produced by orders.

地址：新竹縣新豐鄉新豐村1鄰紅毛23-12號  
No.23-12, HongMao, 1st Neighborhood, Sinfong Village,  
Sinfong Township, HsinChu County, 30472, Taiwan (R.O.C.)

TEL 886-3-5686800  
FAX 886-3-5680390  
E-MAIL decanter@ms10.hinet.net